

RECEIVED
LARAMIE COUNTY
CHEYENNE, WY.

'87 AUG 28 AM 9 09

CERTIFIED LAND CORNER RECORDATION

DESCRIPTION OF CORNER EVIDENCE FOUND, AND ORIGINAL RECORD (if known)

T. 14 N.
1/4 531
56
T. 13 N.
R. 70 W.

FOUND; STANDARD G.L.O. MONUMENT, 1" IRON PIPE WITH 2 1/2" BRASS CAP PROJECTING 0.3 FEET ABOVE GROUND, SLIGHTLY BENT AND STAMPED AS SHOWN BELOW

DESCRIPTION OF MONUMENT AND ACCESSORIES ESTABLISHED TO PERPETUATE THE ORIGINAL LOCATION OF THIS CORNER:

SEE TIES BELOW

SKETCH, WITH COURSE AND DISTANCE TO ADJACENT CORNER IF DETERMINED IN THIS SURVEY. (May Sketch or Paste Reproduction on Reverse Side.)

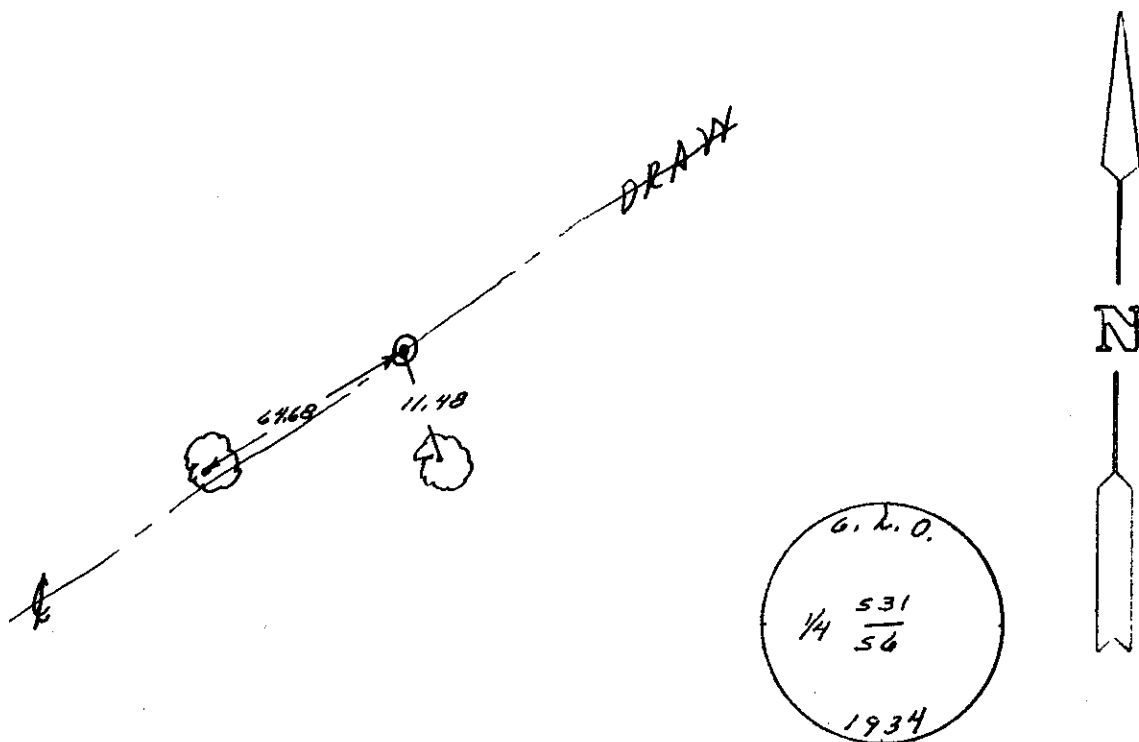

I, JOHN A. STEIL certify that I have carefully performed or reviewed the work done on the diagrammed corner as reported on this recordation form and approve the same.

John A. Steil
Signature of Surveyor

6,525.00
Registration No.

STATE OF WYOMING,
Office of Clerk and Recorder,
County of Laramie

This "corner record" was filed for record on the 28 day of August, 1987, was noted on the cross-index plat and is assigned page No. _____, in _____.

Joseph C. Whitaker
County Official

| | | | |
|----------------------|----------------|----------------|-----------------|
| Index No. <u>A-3</u> | T. <u>13 N</u> | R. <u>70 W</u> | Mer. <u>6th</u> |
| <u>Z-3</u> | T. <u>14 N</u> | R. <u>70 W</u> | Mer. <u>6th</u> |
| _____ | T. _____ | R. _____ | Mer. _____ |
| _____ | T. _____ | R. _____ | Mer. _____ |
| _____ | T. _____ | R. _____ | Mer. _____ |
| _____ | T. _____ | R. _____ | Mer. _____ |
| _____ | T. _____ | R. _____ | Mer. _____ |